

Infection Control Aspect on Environmental Standard on Commissioning

Dr. Raymond Lai
28 Feb 2012

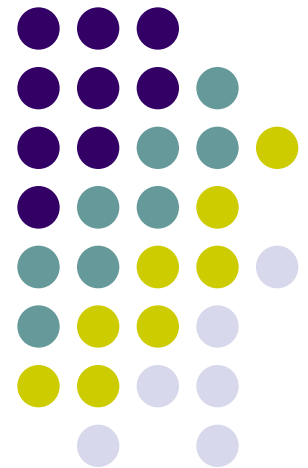



2007.4



2008.5

16/05/2008



2009.8



2010.3



Now



Timeline of Preparation with Infection Control Team



- Steering Committee on Commissioning
- Meetings started from 2008
- Standardization Committee
- Ventilation
- General ward settings related to infection control
- Patient flow
- Work flow

Ground Floor 地下

Bus/MTR Station
巴士或馬鐵站

Ambulance
救護車

Magnetic Resonance
Imaging Centre
磁力共振中心

Lobby
大堂

Accident and
Emergency
Department
創傷及急症中心

Mortuary
殮房

威爾斯親王醫院新住院主樓暨創傷中心

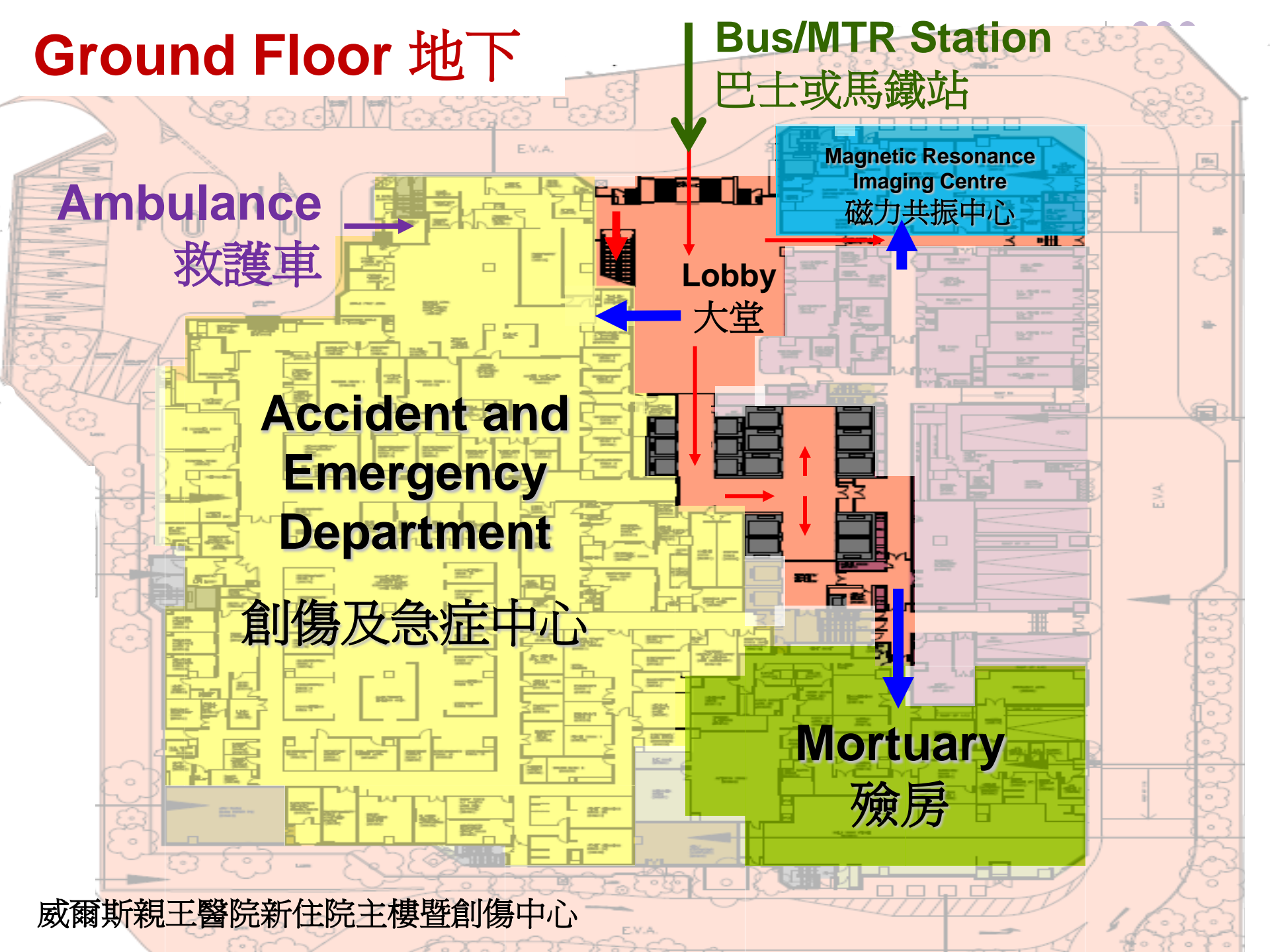

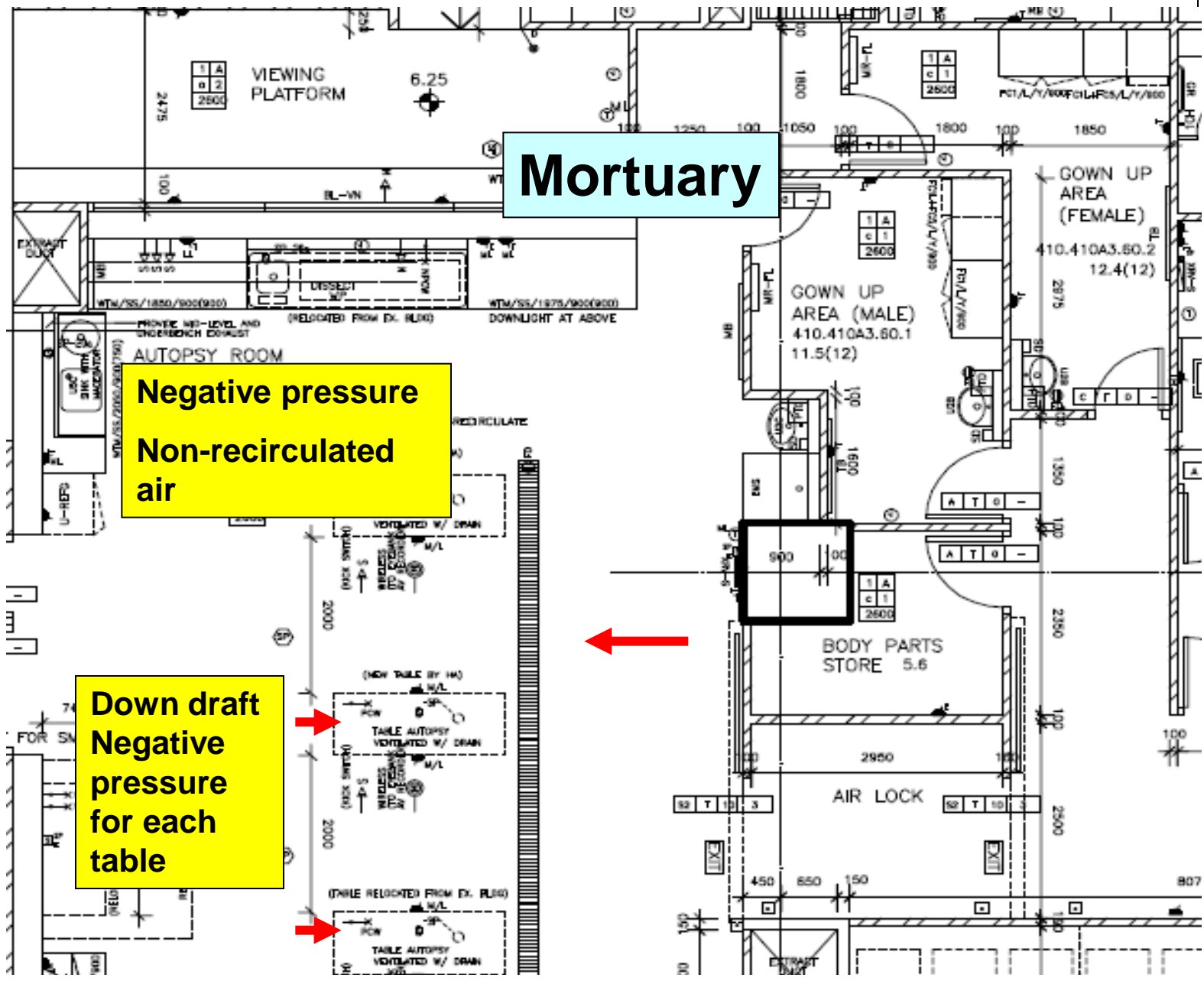
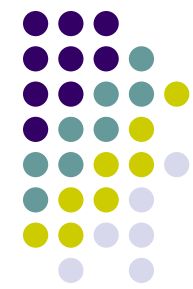

3rd Floor 三樓

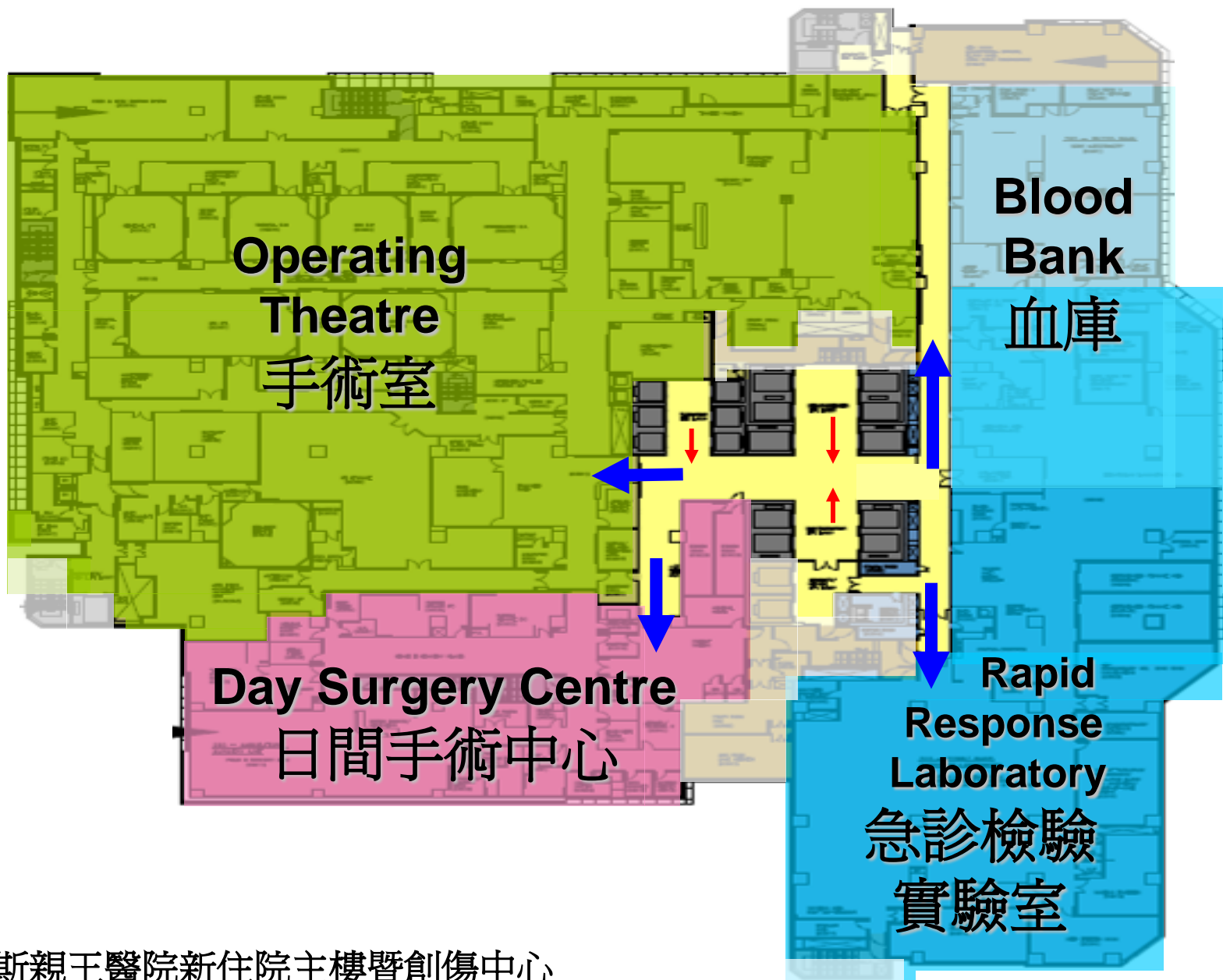

5th Floor 五樓

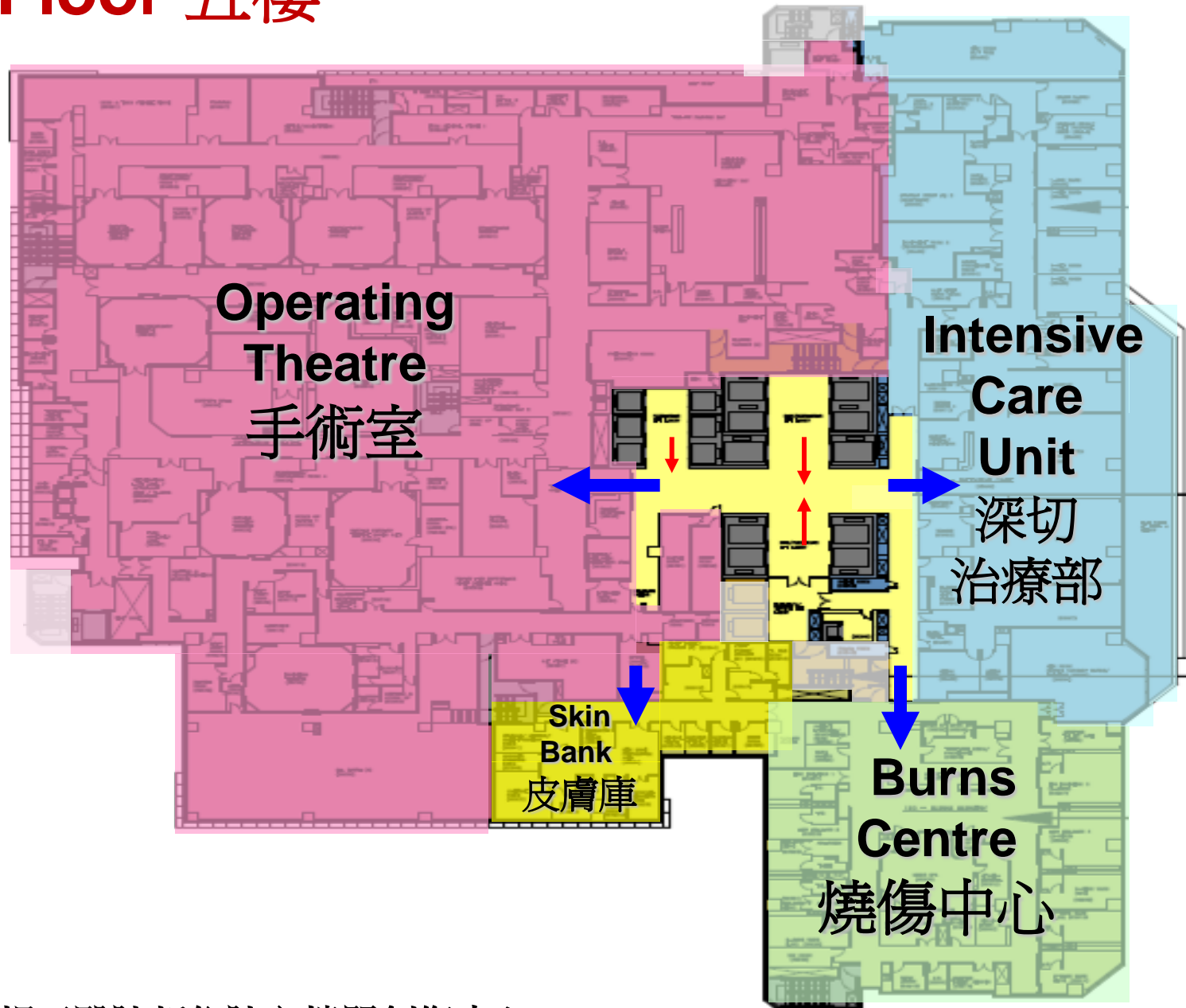

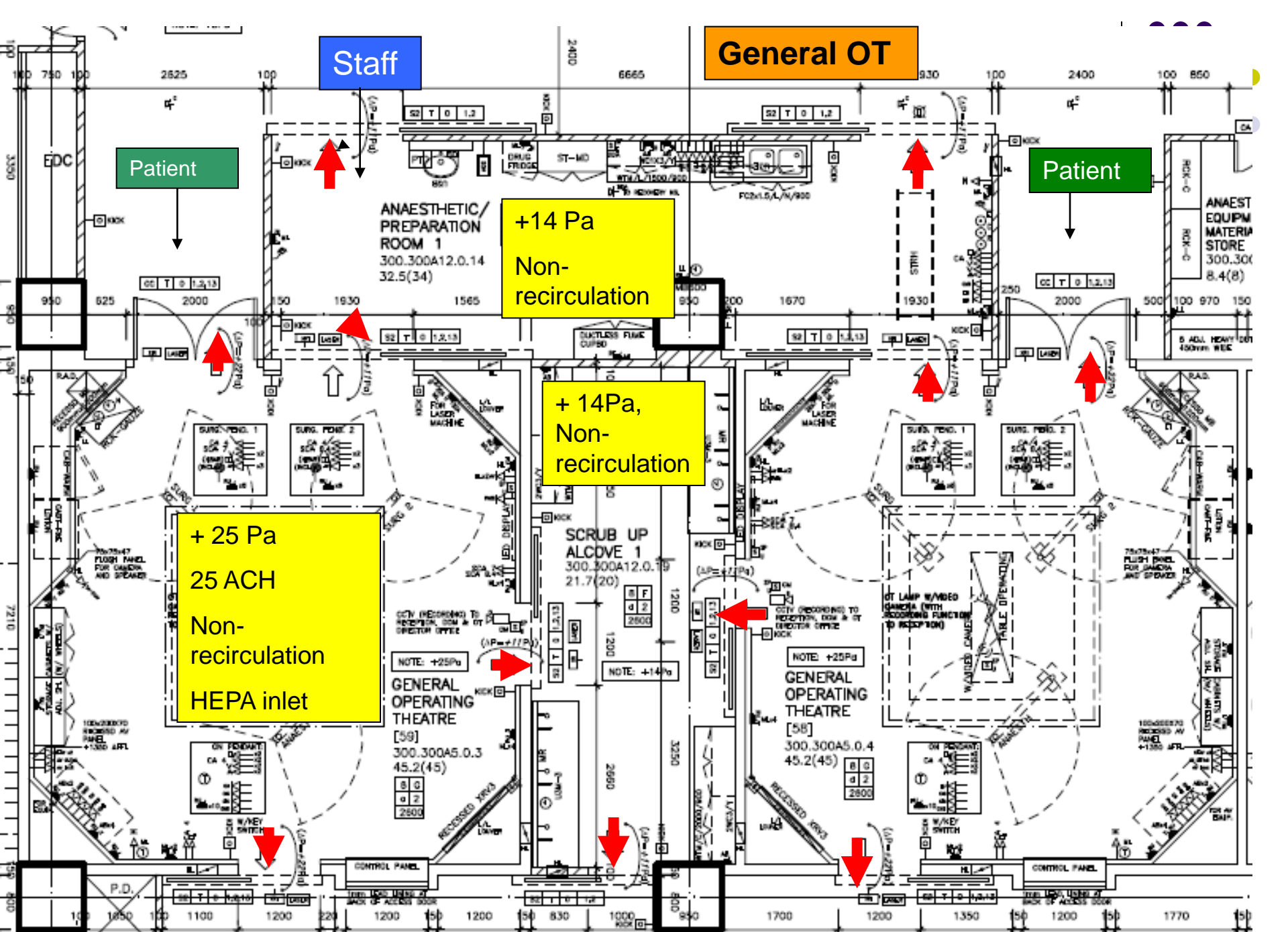

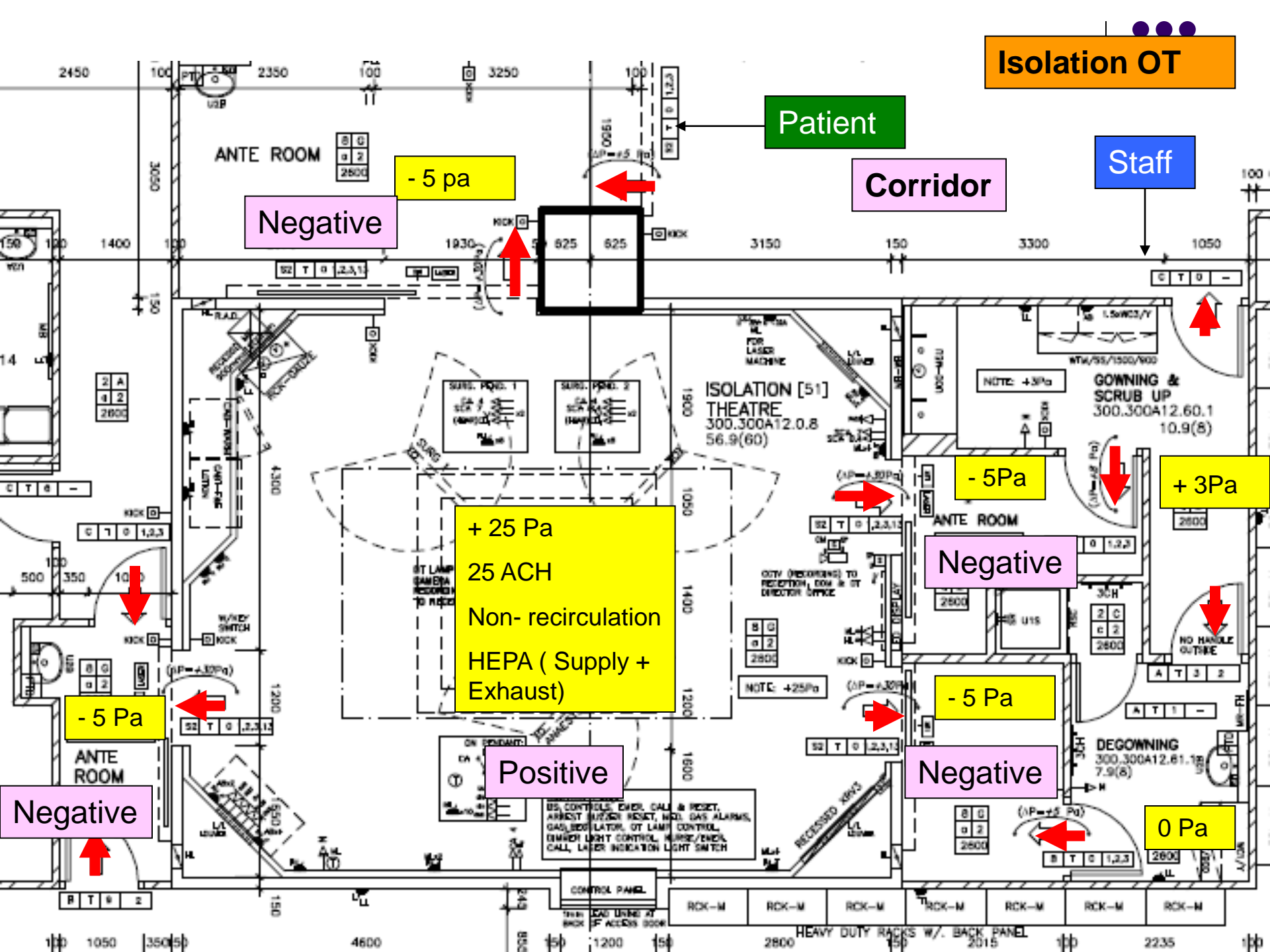

Isolation OT

Patient

Staff

Corridor

Negative

- 5 pa

+ 25 Pa
25 ACH
Non-recirculation
HEPA (Supply + Exhaust)

Negative

- 5Pa

+ 3Pa

- 5 Pa

Negative

Positive

- 5 Pa

Negative

0 Pa

CSSD & TSSU Sterile store

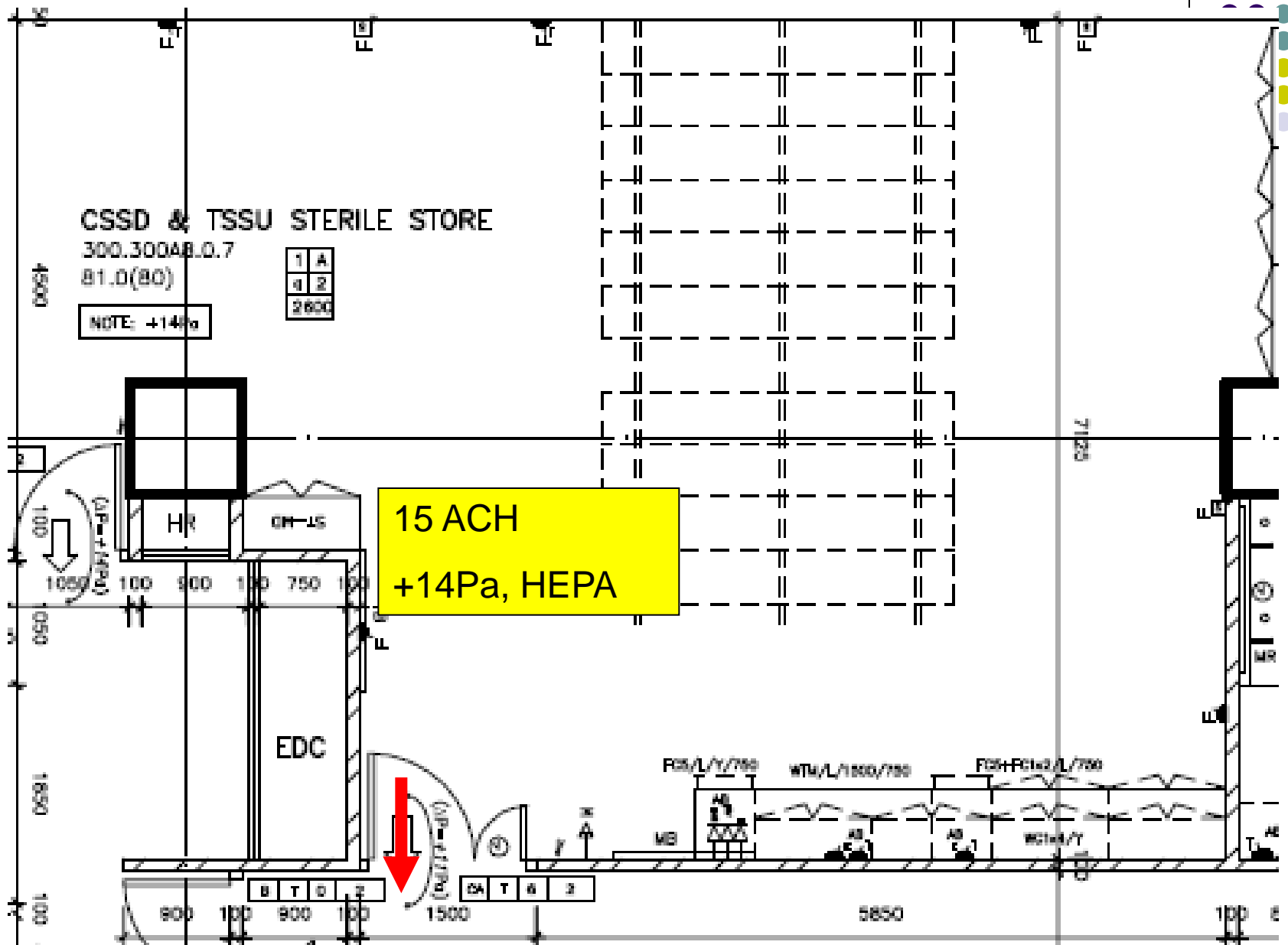
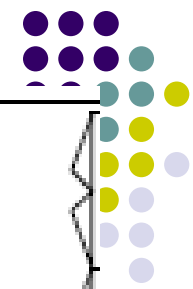

CSSD / TSSU - Consideration



- Well segregated clean and dirty zone
- Double doors sterilizers and washer disinfectors – one way in and the other way out
- Installation of R/O machine to generate purified water and steam
- Replace linen with disposable wrapper and drapes – pass the particle count required in the ISO 14644 class 8 standard
- Consider the space for central disinfection / sterilization
- Avoid to have water pipes and sewage pipes above the ceilings of CSSD / TSSU



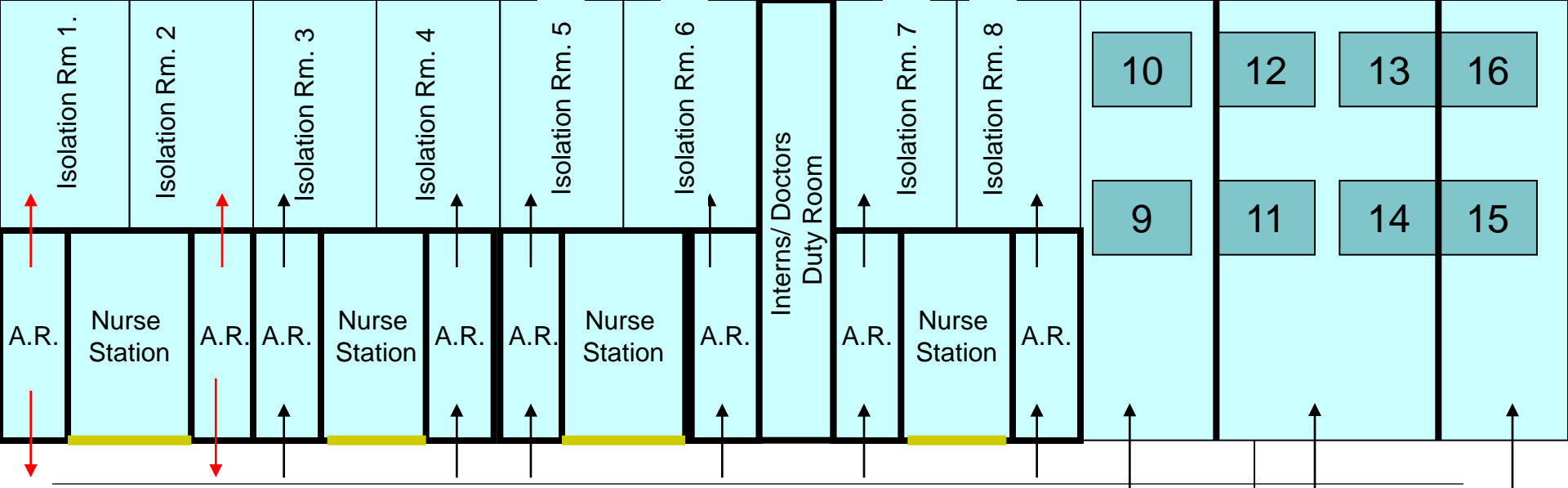

4/F ICU

(Prepared for Infectious Disease Epidemics)

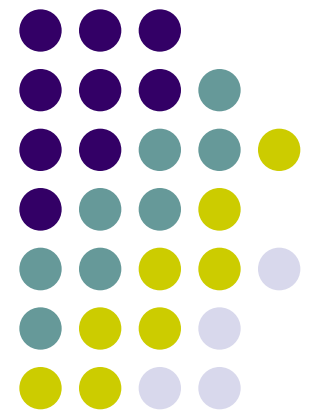

Ward Entrance

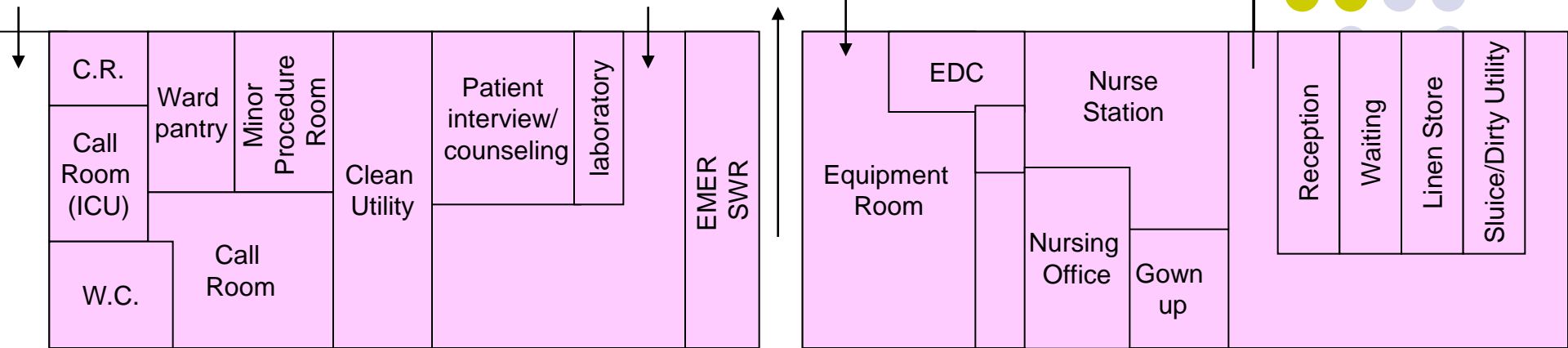

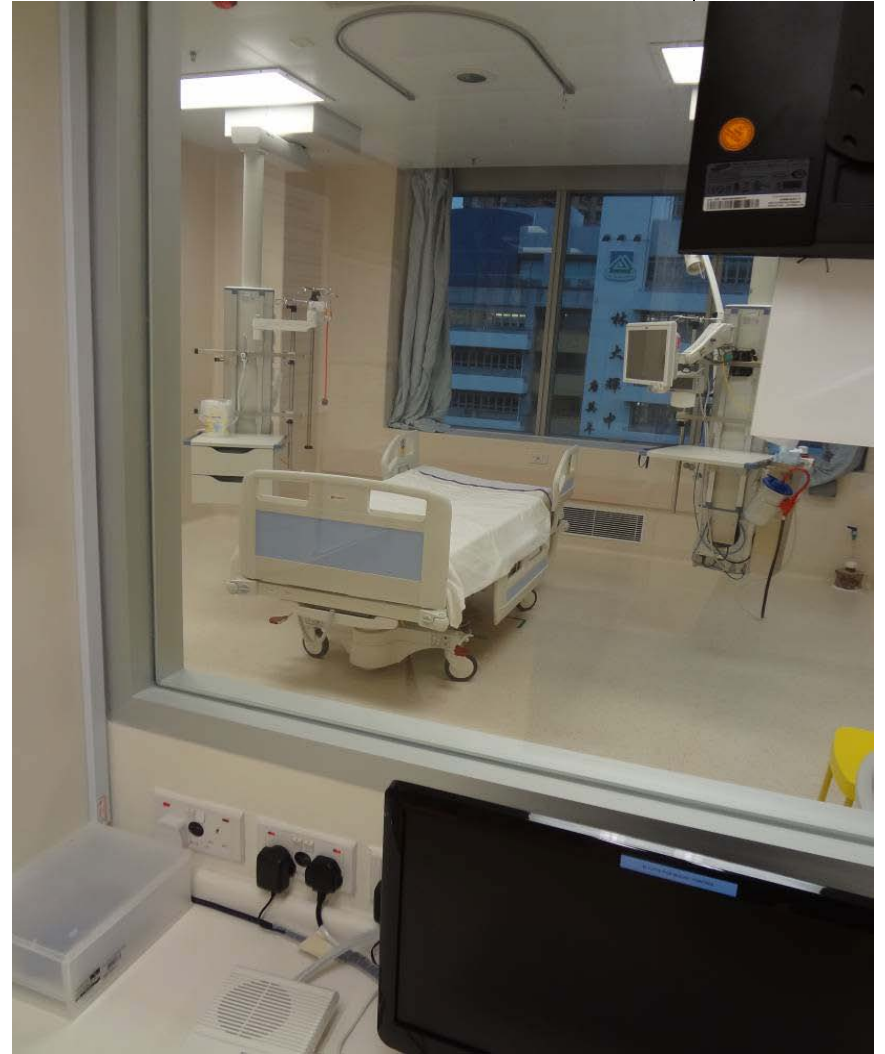

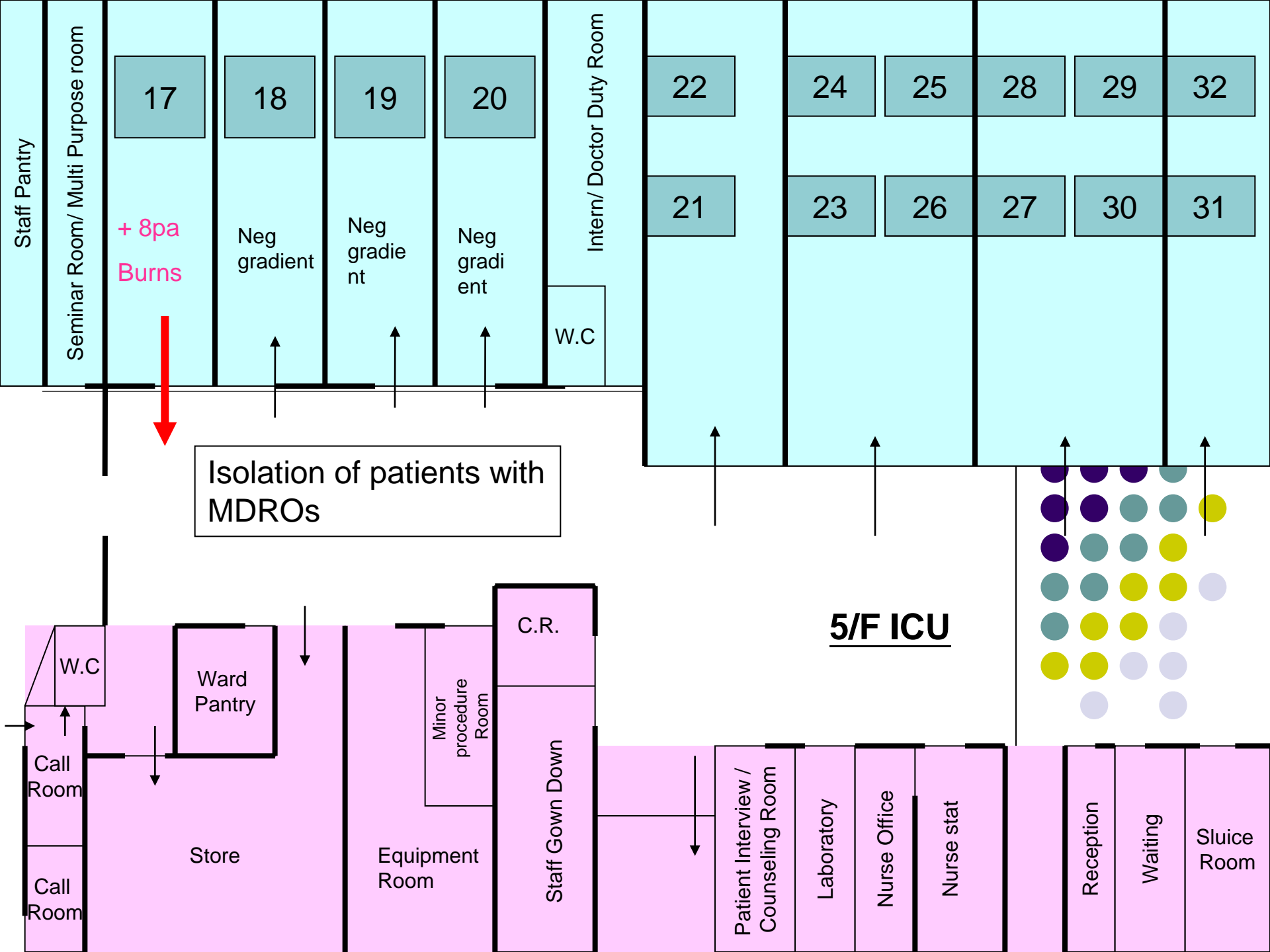

Staff Pantry

Seminar Room/ Multi Purpose room

17

18

19

20

Intern/ Doctor Duty Room

22

24

25

28

29

32

+ 8pa
Burns

Neg gradient

Neg gradie
nt

Neg gradi
ent

W.C

21

23

26

27

30

31

Isolation of patients with MDROs

5/F ICU

C.R.

W.C

Ward Pantry

Call Room

Store

Equipment Room

Minor procedure Room

Staff Gown Down

Patient Interview / Counseling Room

Laboratory

Nurse Office

Nurse stat

Reception

Waiting

Sluice Room

Call Room

12th Floor 十二樓

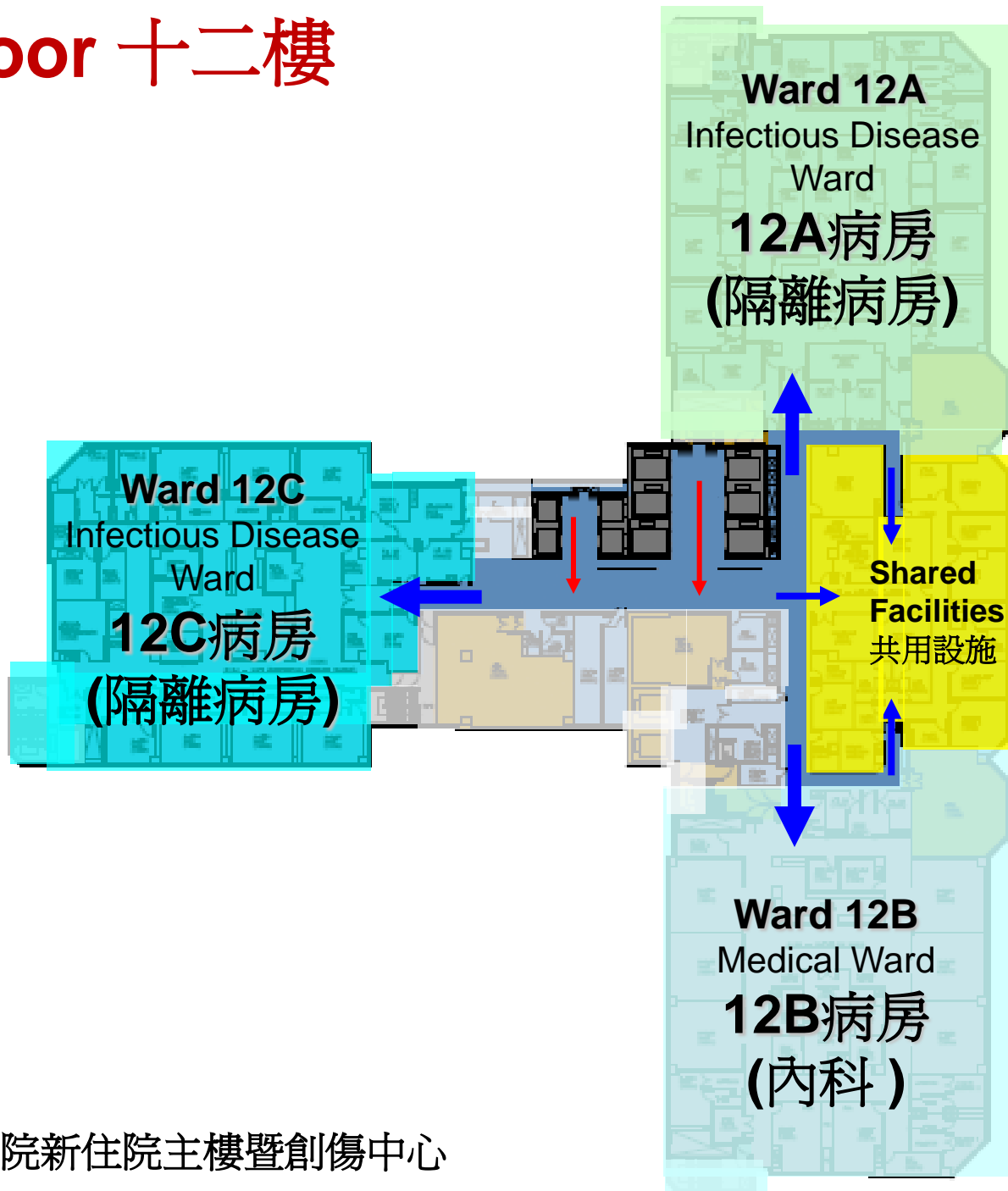

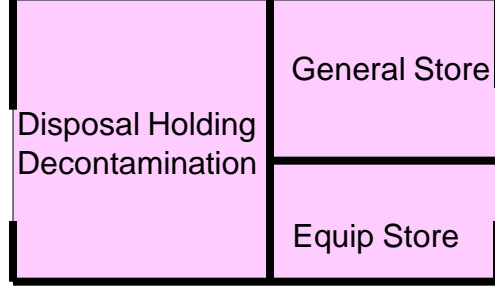
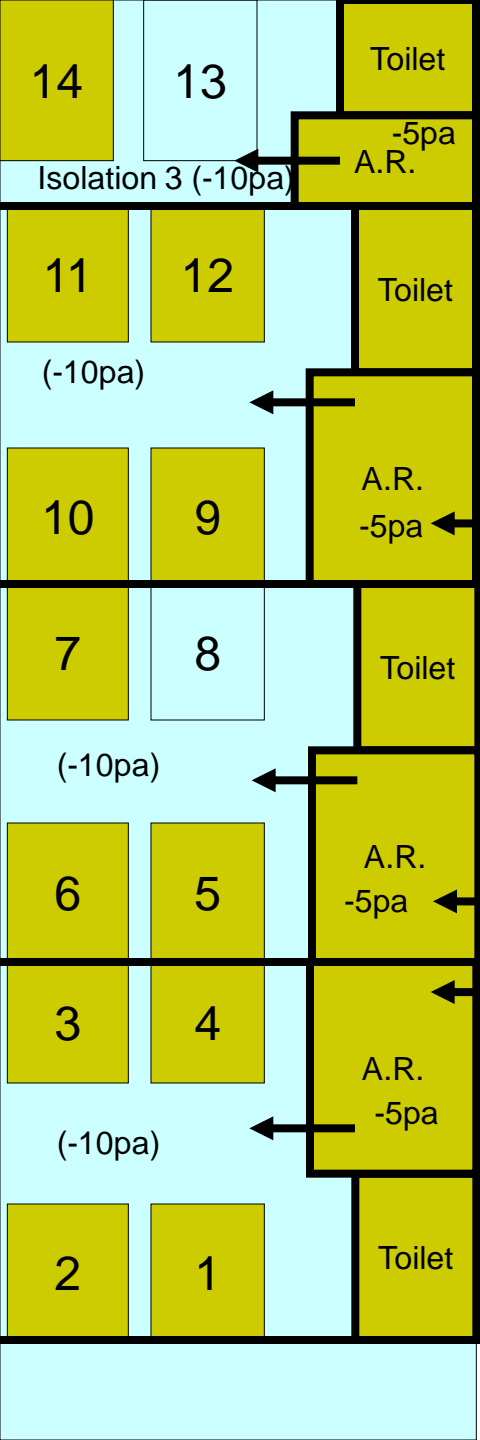

12C-ID Ward

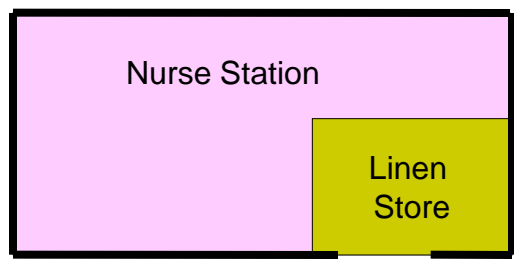
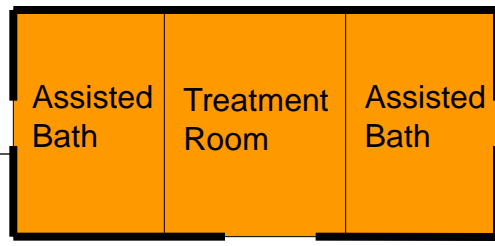

4 Bed cubicles

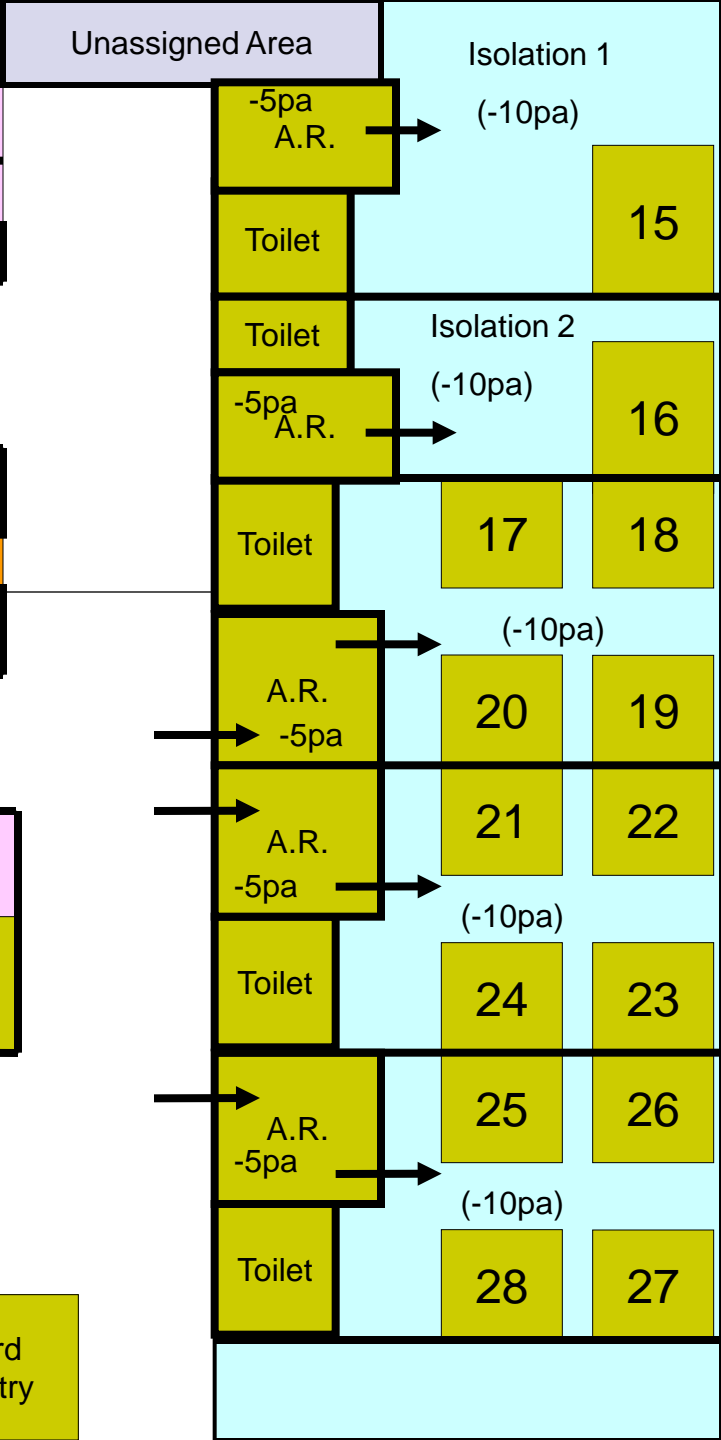
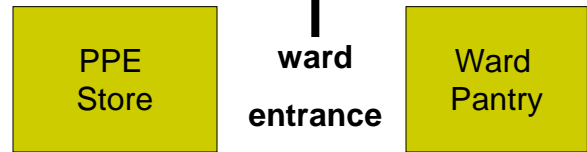

Low level exhaust

Isolation ward – patient cubicle

Low level exhaust

- 10 Pa

- 5pa

Low level exhaust

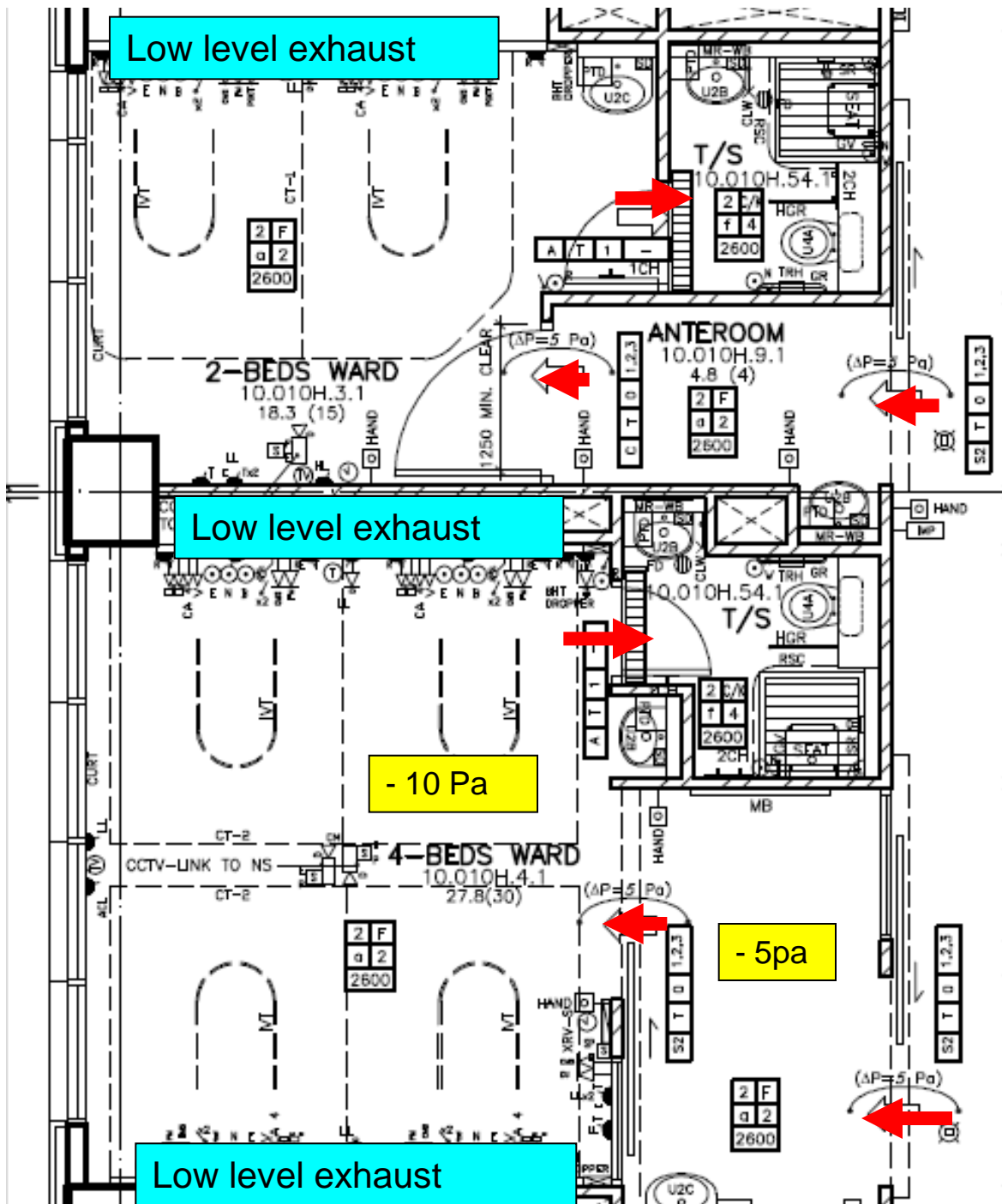

8th Floor 八樓

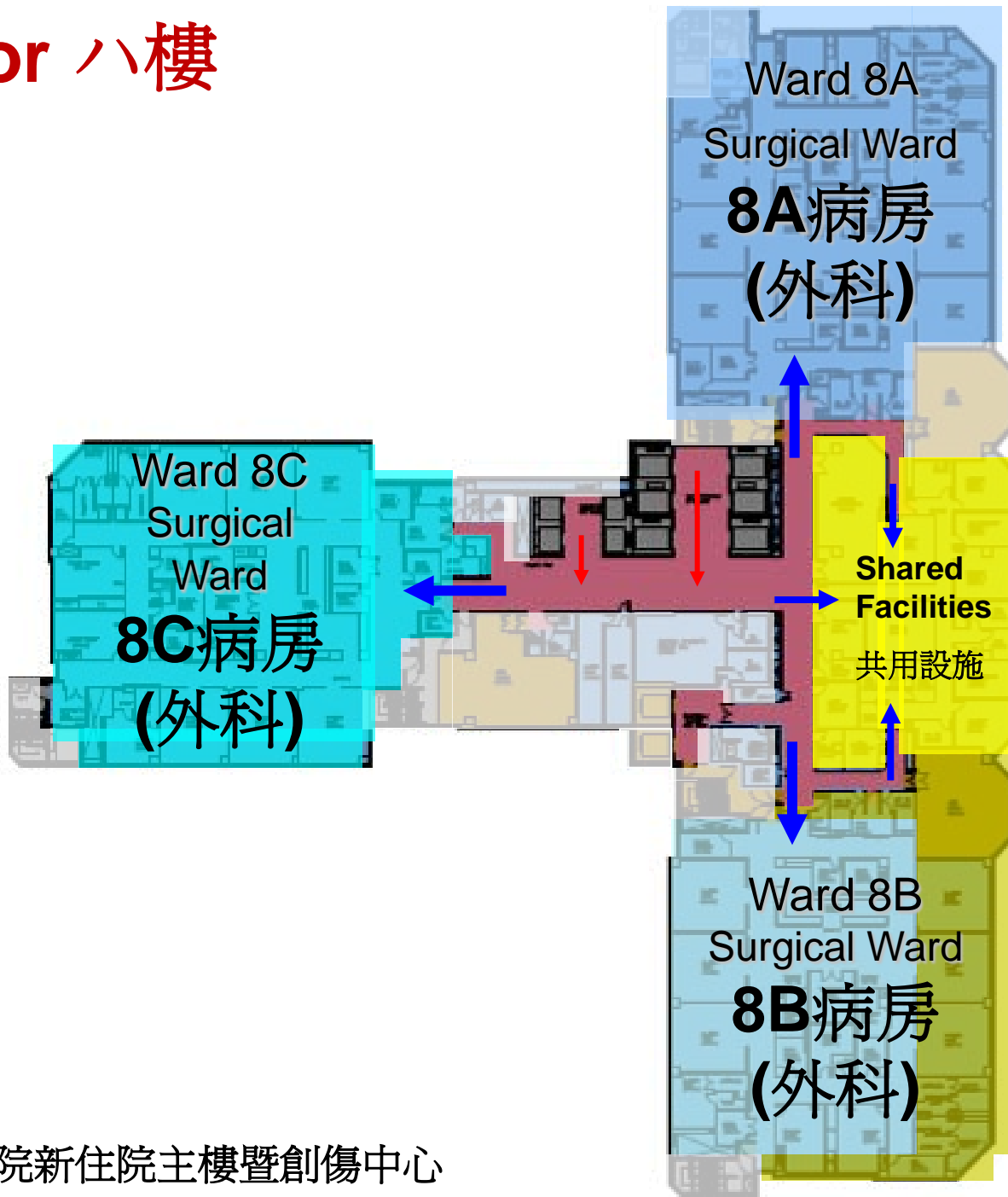
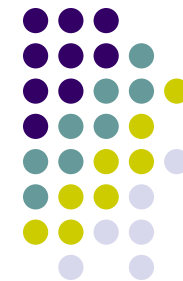

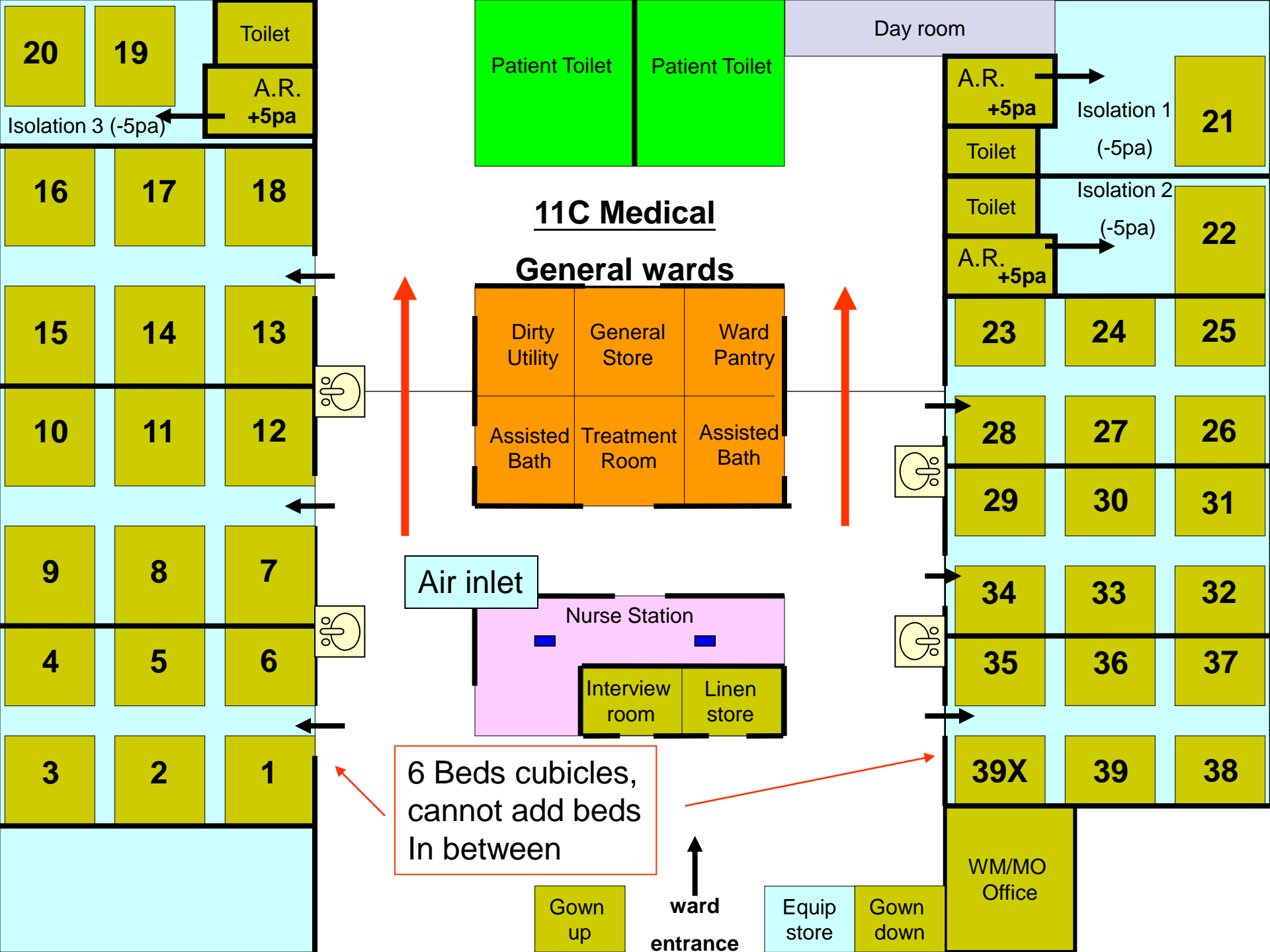



General ward – Gown Up and Gown down

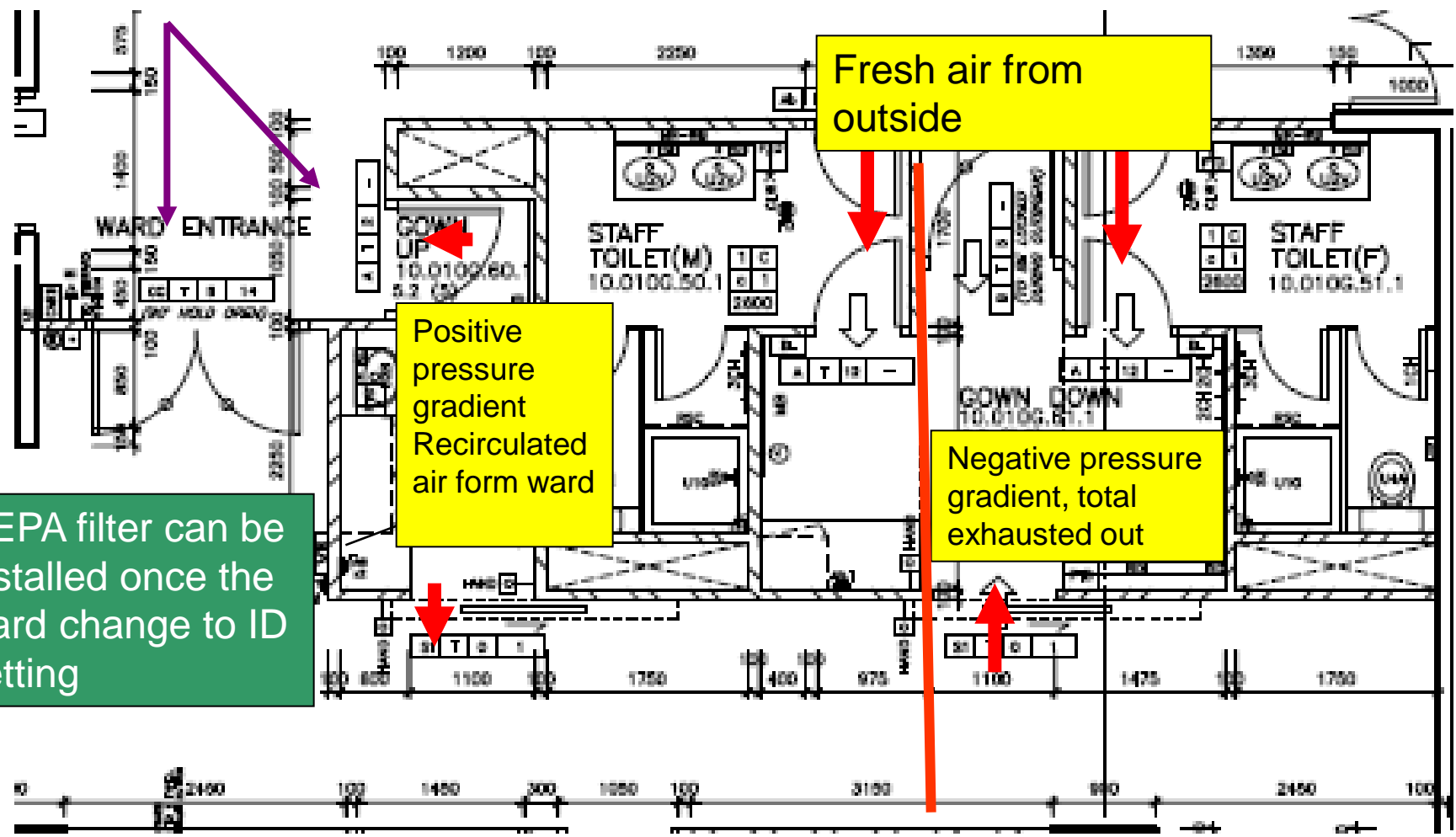

HEPA filter can be installed once the ward change to ID setting

General ward – Isolation room

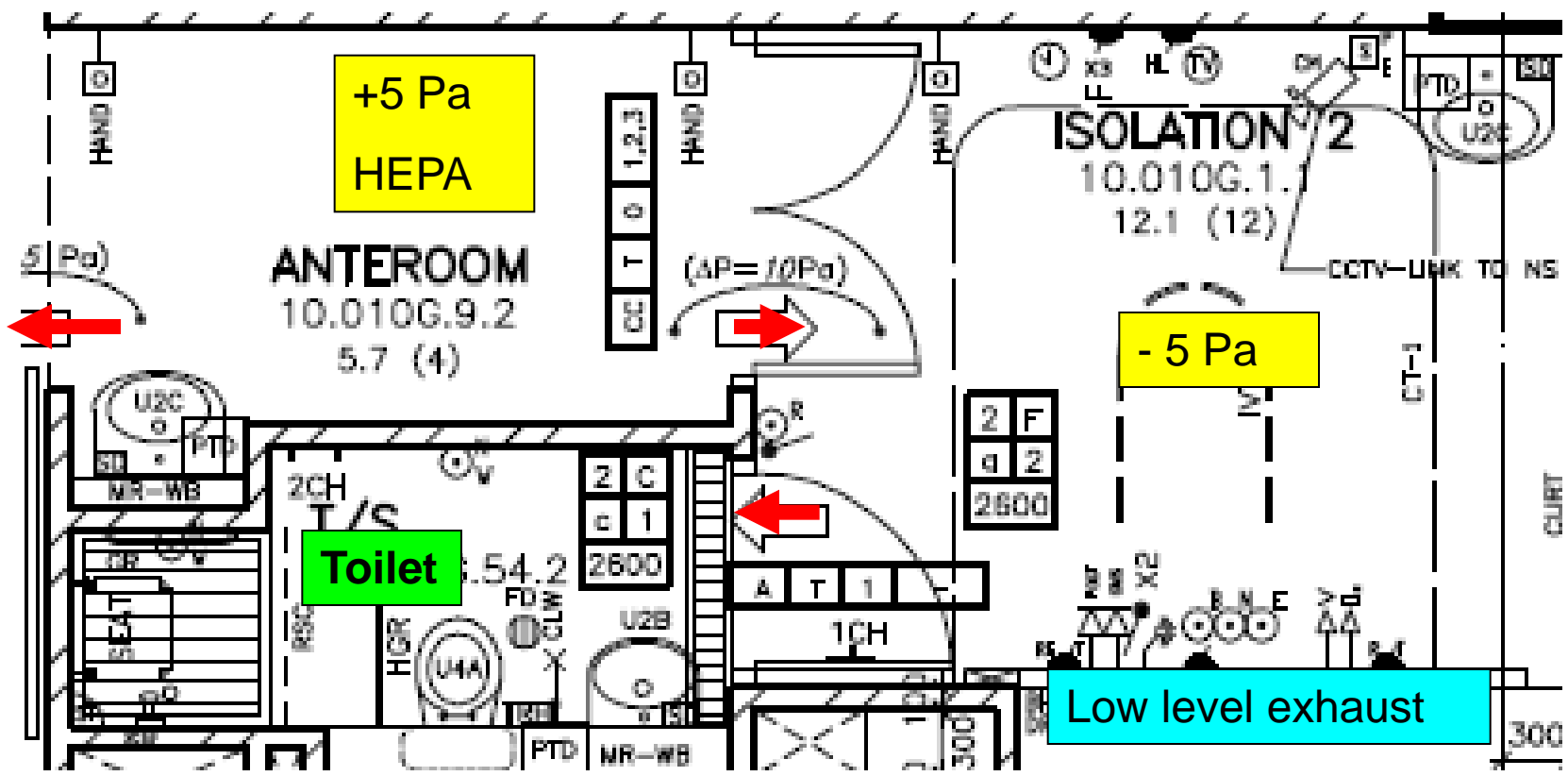



Old waste chute in Old Block

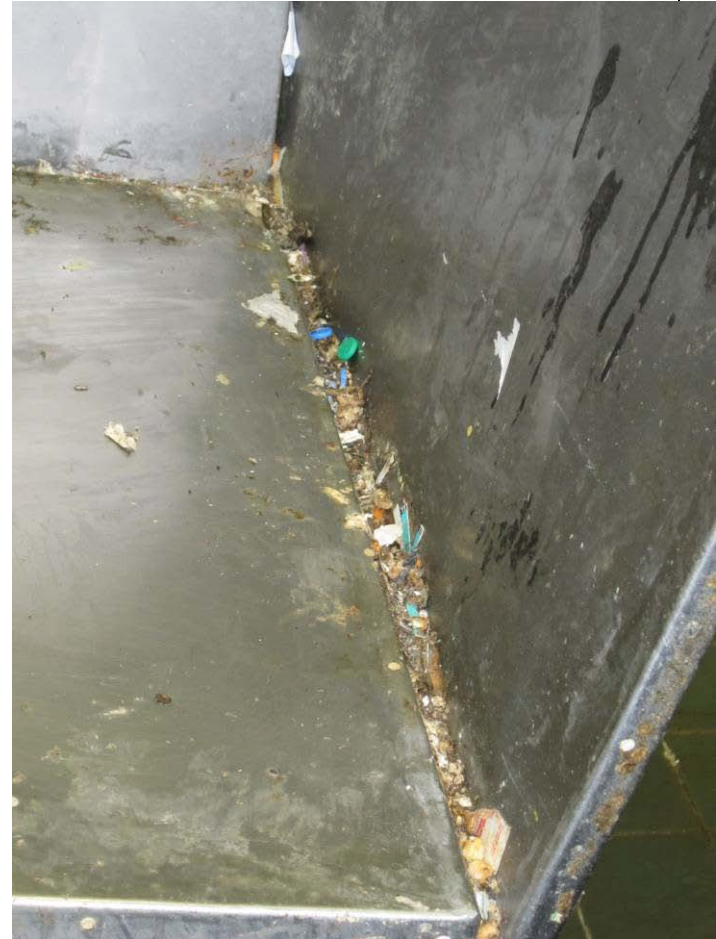

New waste storage area



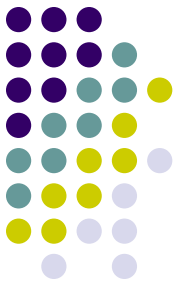

Clinical waste room



Checking on Completion



Isolation room monitoring panel



Standardization

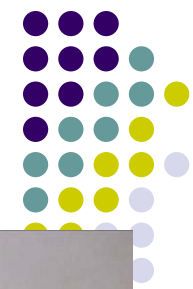

Site discussion



Gown up PPE



Poster

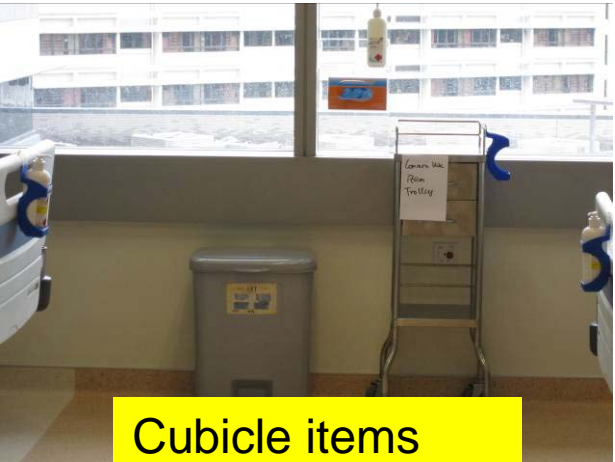

Cubicle items



AHR set up

出
OUT

**除防護裝備
請跟次序**
Removing PPE
Step by Step

- 1  **除手套**
Remove Gloves
- 2  **潔手**
Perform Hand Hygiene
- 3  **除隔離衣**
Remove Gown
注意：內面外翻
Folding Inside Out
- 4  **潔手**
Perform Hand Hygiene
- 5  **除帽及護眼罩/
全面罩**
Remove Disposable Cap
and Eye Protection
- 6  **潔手**
Perform Hand Hygiene
(必需)
Essential
- 7  **除口罩/
N95口罩**
Remove Mask /
N95 Respirator
- 8  **再潔手**
Perform Hand Hygiene
AGAIN

注意：請將用過的防護裝備妥善貯存或棄掉
Note: Disposable PPE should be properly
disposed to prevent infection

N95呼吸器配戴方法
Use of N95 respirator



Positive Pressure Test

- * Place both hands completely over the respirator and exhale.
- * If air leaks around respirator edges, readjust the nosepiece and straps accordingly

**Remember Fit Check
請緊記密合性檢查**

正壓測試：

- * 以雙手遮著口罩，然後大力呼氣。
- * 如空氣從口罩邊緣溢出，表示佩戴不當，必須再次調校頭帶及鼻樑金屬條。

新界東醫院聯網 感染控制組 2006
NTEC Infection Control Unit 2006

N95呼吸器卸下方法
Removal of N95 respirator

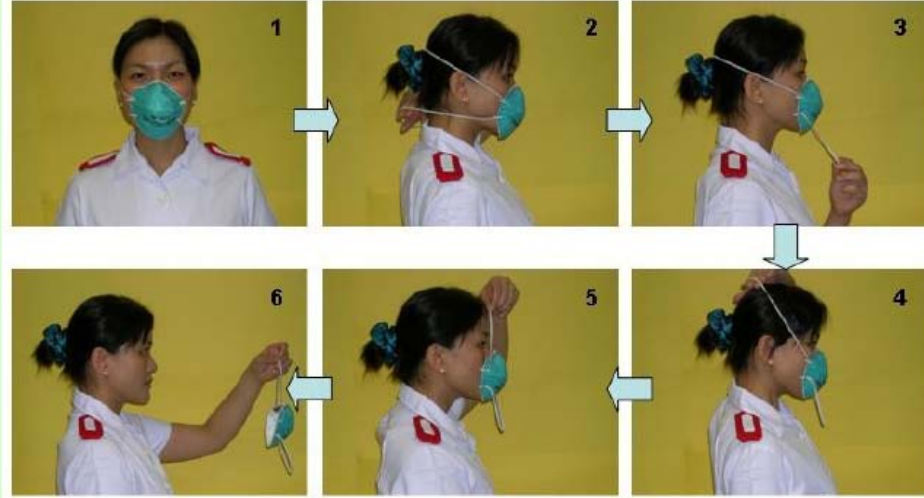

新界東醫院聯網 感染控制組 2006
NTEC Infection Control Unit 2006

入
IN

**穿防護裝備
請跟次序**
Donning PPE
Step by Step

- 1  **潔手**
Perform Hand Hygiene
- 2  **戴口罩/
N95口罩**
Put on Mask /
N95 Respirator
+ 緊記密合性檢查
Remember to
Perform Seal Check
- 3  **戴護眼罩/
全面罩及帽**
Put on Eye Protection
and Disposable Cap
- 4  **穿隔離衣**
Put on Gown
- 5  **戴手套**
Put on Gloves

注意：選擇防護裝備及穿戴順序應基於風險評估
Note: Selection of PPE should
be based on risk assessment

rubbish bin with lid

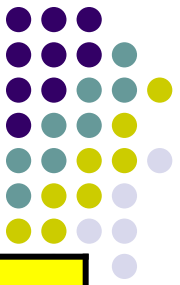

Large		Medium	
Gown down area	1	Cubicle	6
Dirty utility	1	Gown up area	1
Treatment room	1	Isolation rooms	2
Toilet	2	Corridor	2
Assisted bath	2	Nurses station	3
660L refuse bin for domestic waste	1	Equipment store	?
		General store	?
		Interview room	1
		Day room	1
		Staff toilet	1

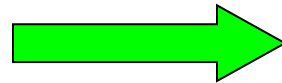
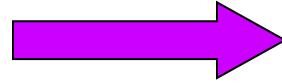
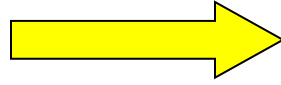



新大樓 ■ 新面貌

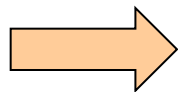

Patient areas



Patient Toilets



新大樓 ■ 新面貌



護士站

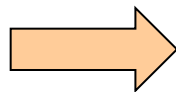

升降機

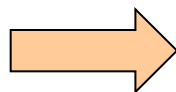

Thank You!

